

**APPENDIX W**

**SANITARY SEWER CONNECTION DISTRICT MAPS AND SCHEDULE  
OF FEES AND WATER CONNECTION DISTRICT MAP AND  
SCHEDULE OF FEES**

---

**SANITARY SEWER CONNECTION DISTRICT SCHEDULE OF FEES**

*Sanitary Sewer Connection District #1 (All parcels)*

<b>Effective Date</b>	<b>Connection Fee (\$/acre) 5% Annual Increase</b>
Adoption of Ordinance	\$1,641.36
July 1, 2015	\$1,724.00
July 1, 2016	\$1,807.00
July 1, 2017	\$1,890.00
July 1, 2018	\$1,973.00
July 1, 2019	\$2,056.00
July 1, 2020	\$2,139.00
July 1, 2021	\$2,222.00
July 1, 2022	\$2,305.00
July 1, 2023	\$2,388.00
July 1, 2024	\$2,471.00
July 1, 2025	\$2,554.00

***Sanitary Sewer Connection District #2 (Parcels 6, 7, 8, 9)***

<b>Effective Date</b>	<b>Additional Connection Fee (\$/acre) 5% Annual Increase</b>	<b>Total Connection Fee (\$/acre) District #1 Connection + District #2 Additional Connection Fee</b>
Adoption of Ordinance	\$1,204.80	\$2,846.16
July 1, 2015	\$1,265.00	\$2,989.00
July 1, 2016	\$1,325.00	\$3,132.00
July 1, 2017	\$1,385.00	\$3,275.00
July 1, 2018	\$1,445.00	\$3,418.00
July 1, 2019	\$1,505.00	\$3,561.00
July 1, 2020	\$1,565.00	\$3,704.00
July 1, 2021	\$1,625.00	\$3,847.00
July 1, 2022	\$1,685.00	\$3,990.00
July 1, 2023	\$1,745.00	\$4,133.00
July 1, 2024	\$1,805.00	\$4,276.00
July 1, 2025	\$1,865.00	\$4,419.00

***Sanitary Sewer Connection District #3 (Parcel 16)***

<b>Effective Date</b>	<b>Additional Connection Fee (\$/acre) 5% annual increase</b>	<b>Total Connection Fee (\$/acre) District #1 Connection + District #2 Additional Connection Fee</b>
Adoption of Ordinance	\$1,341.53	\$2,982.89
July 1, 2015	\$1,409.00	\$3,133.00
July 1, 2016	\$1,476.00	\$3,283.00
July 1, 2017	\$1,543.00	\$3,433.00
July 1, 2018	\$1,610.00	\$3,583.00
July 1, 2019	\$1,677.00	\$3,733.00
July 1, 2020	\$1,744.00	\$3,883.00
July 1, 2021	\$1,811.00	\$4,033.00
July 1, 2022	\$1,878.00	\$4,183.00
July 1, 2023	\$1,945.00	\$4,333.00
July 1, 2024	\$2,012.00	\$4,483.00
July 1, 2025	\$2,079.00	\$4,633.00

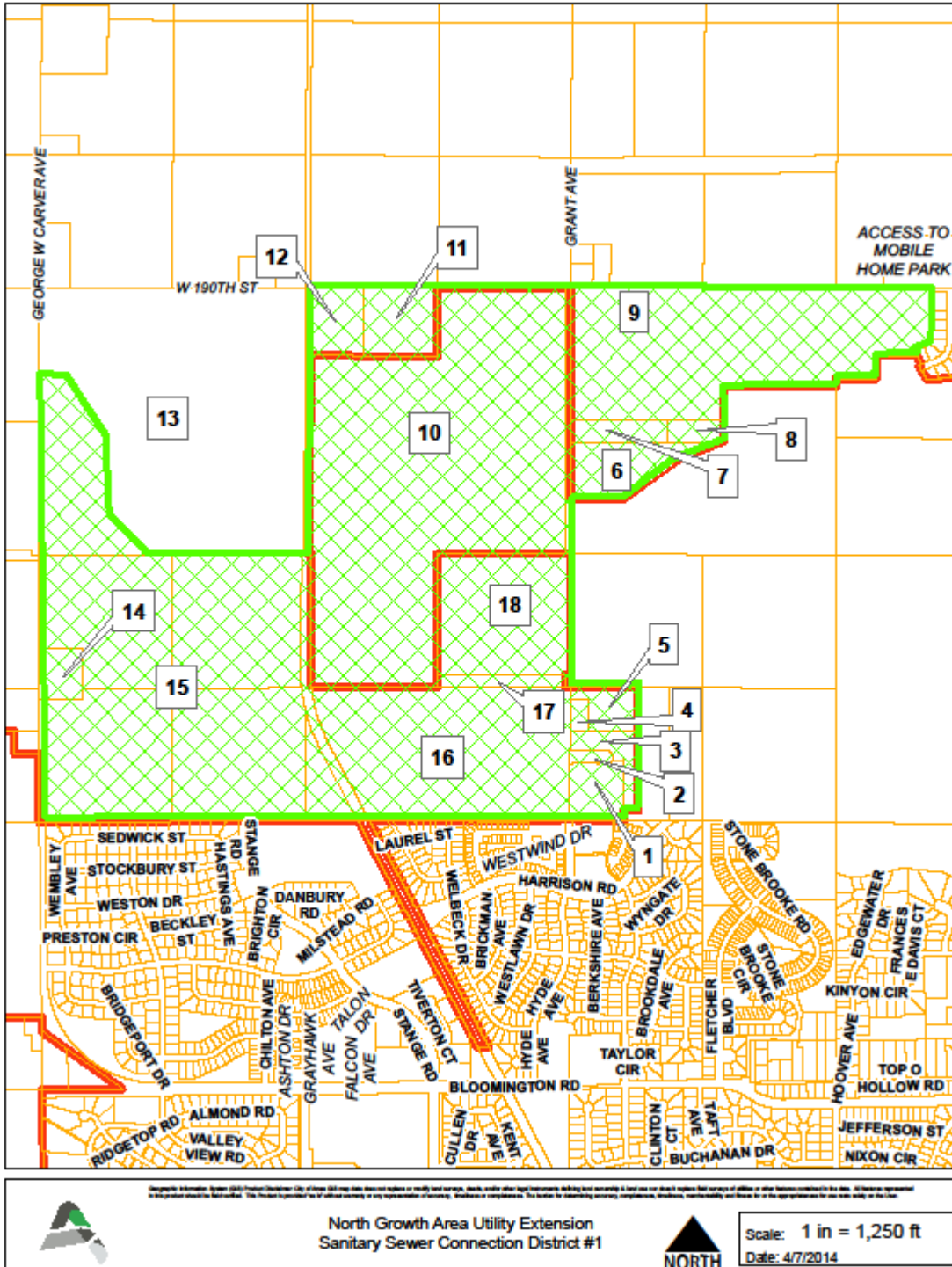

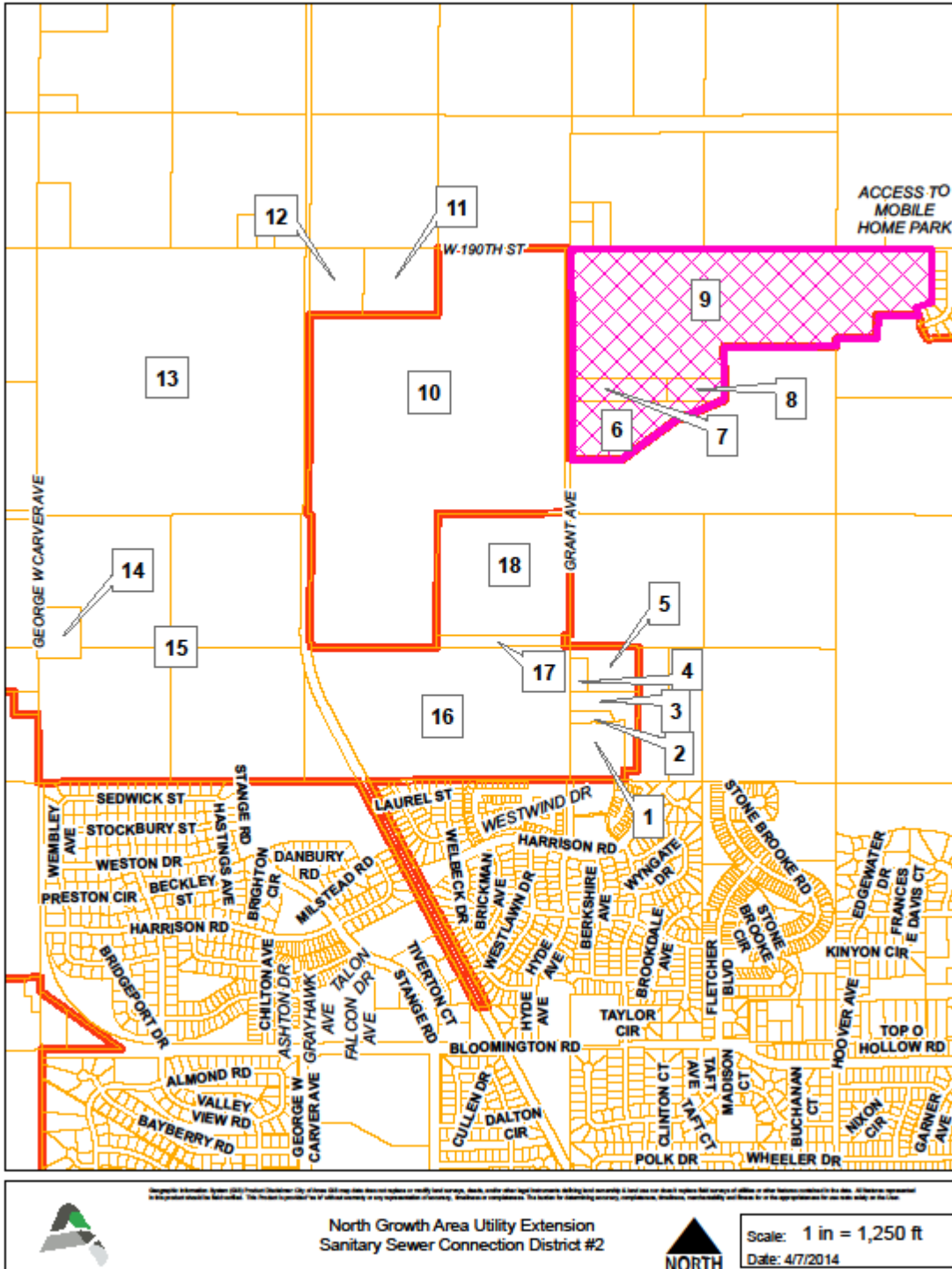

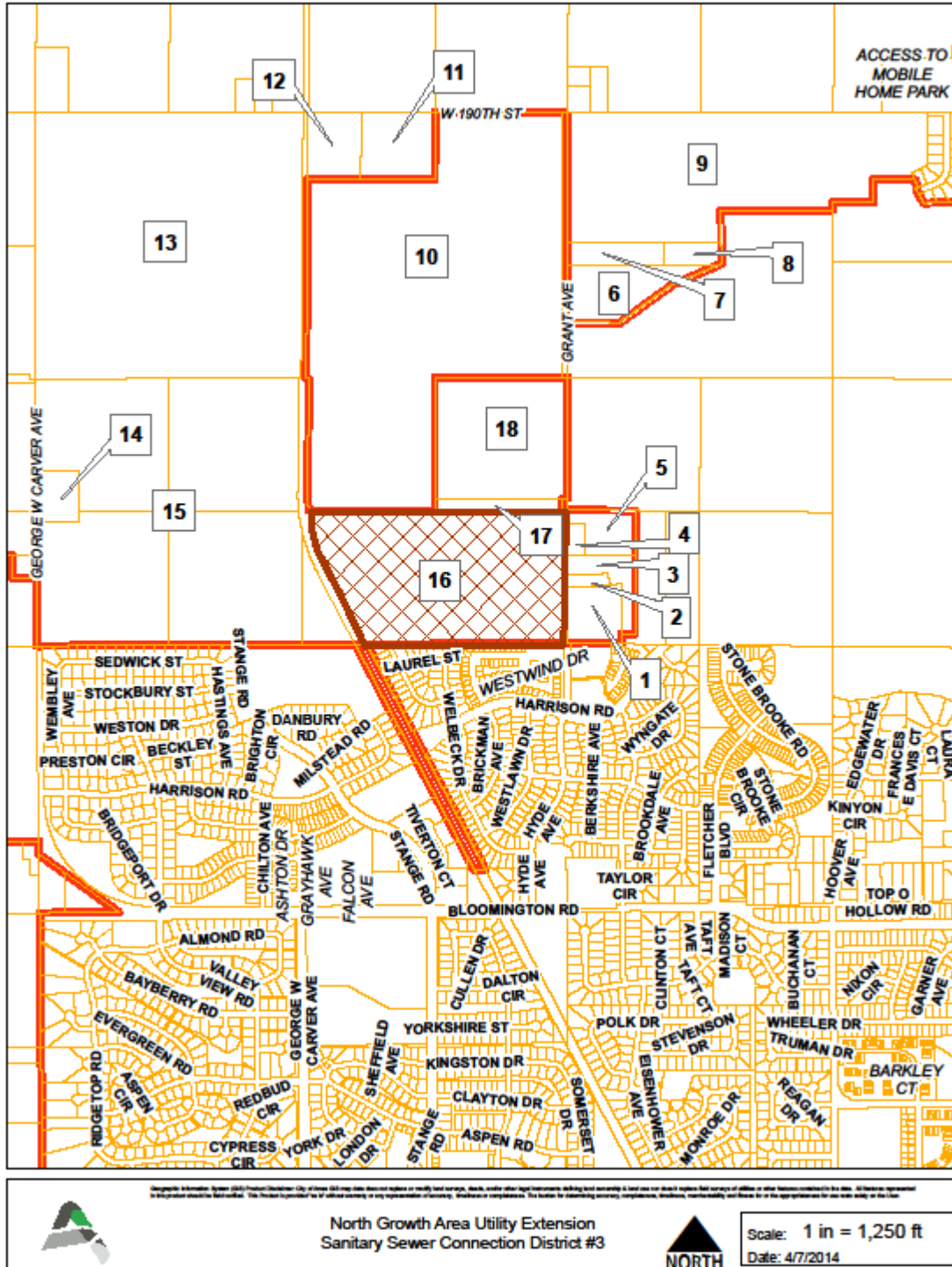

**WATER CONNECTIONDISTRICT SCHEDULE OF FEES**

***Water Connection District***

<b>Effective Date</b>	<b>Connection Fee (\$/acre) 5% annual increase</b>
Adoption of Ordinance	\$1,084.24
July 1, 2015	\$1,139.00
July 1, 2016	\$1,194.00
July 1, 2017	\$1,249.00
July 1, 2018	\$1,304.00
July 1, 2019	\$1,359.00
July 1, 2020	\$1,414.00
July 1, 2021	\$1,469.00
July 1, 2022	\$1,524.00
July 1, 2023	\$1,579.00
July 1, 2024	\$1,634.00
July 1, 2025	\$1,689.00

